



2750 Hugh Moore Park Road  
Easton, PA 18042  
Tel 610.923.3548  
Fax 610.923.0537  
[www.delawareandlehigh.org](http://www.delawareandlehigh.org)

June 29, 2017  
Bid Addendum #1  
Dry Run Pedestrian Bridge  
Delaware & Lehigh National Heritage Corridor

1. Paragraph 9.2 states "Contractor shall include a contingency allocation, with unit prices for extra excavation and material." What does this mean and is it required to be submitted with the bid? Paragraph 9.2 also states "Quantities shown on the bid form are approximate, actual payment will be based on measured quantities." There is not schedule of bid items with corresponding quantities on the Bid Form. Please confirm the bid amount is to be one lump sum amount for the entire job.
  - a. We would like to have included in the initial bid a sum to cover expenses in the event that additional excavation or material is needed at or around the abutment construction. Attached is an amended Bid Form with line items for including the contingency allocations for extra excavation and crushed aggregate backfill.
  - b. Please add the base bid lump sum price with the total contingency allocation items to create the total sum for the project.
2. How many linear feet of "wet canal basin" will need to have geotextile and stone placed temporarily to improve access?
  - a. Roughly 600 linear feet.
3. Bridge Plan Sheet 9 of 11 shows waterproofing membrane over the timber decking on the Deck Joint Angle Detail. Is the deck to be covered with waterproofing membrane?
  - a. No, no membrane on the bridge deck
4. Is Attachment J "Criminal History Verification Form" required to be submitted with the bid?
  - a. Only the awarded contractor will be required to submit the Criminal History Verification form.
5. E&S Sheet 4 of 5: Typical Approach Section says "contractor to rough grade approaches". The section also shows a 4" layer of 2A subbase. Is the 2A subbase final surfacing of the trail part of this contract?
  - a. Yes.
6. Are there designs for the causeway crossing at Dry Run as outlined in the GP8 Permit?
  - a. Yes, the E&S plan for the Causeway is attached.
7. Given the access issues, what is the overall timeline of the project?
  - a. While the engineer estimates that the bridge will take roughly 90 days to construct, the contract allows for 150 days from the Notice to Proceed. The D&L understands that access and mobilization will be impacted by Trumbull's opening of the construction access. We have a funding deadline of May 31, 2018 for the project, which is the absolute last day construction can occur.
8. Sheet 2 of 5 on the E&S Plan notes "Should the contractor disturb any additional acreage due to the contractor's method of operations, the contractor will be solely responsible for obtaining any additional required permits and for notifying the PA DEP." Does this note pertain only to the limits of disturbance shown at the bridge construction site (9000 SF +/-) or will the contractor be required to obtain PA DEP approval for his means and methods to construct the access road?
  - a. If the contractor utilizes geotextile and rock or crane pads to temporarily reinforce the access road then it will not

be considered disturbance and thus will not require any additional permits. If the contractor breaks ground or clears AND grubs vegetation then they will be responsible for obtaining any additional permits. Clearing down to the ground line is acceptable and is not considered disturbance.

9. Trumbull Corporation will require that the awarded contractor fulfill their insurance requirements in order to pass through their project site. What are these insurance requirements?
  - a. Only the awarded contractor will be required to fulfill these requirements, but for the purposes of this bid please reference PennDOT standard construction insurance requirements.

**BID FORM**

**DRY RUN BRIDGE  
Northampton, Pennsylvania**

**DELAWARE & LEHIGH NATIONAL HERITAGE CORRIDOR, INC.**

We, \_\_\_\_\_, on this the \_\_\_\_\_ day of \_\_\_\_\_, 2017 hereby:  
(Bidder's Name)

- Propose to furnish all labor, materials, equipment and services required to construct and complete the D&L Trail-Lehigh valley Connectivity Project- Dry Run Bridge for the Delaware & Lehigh National Heritage Corridor, Inc., in accordance with the project Bid Documents, for the firm base bid sum of \_\_\_\_\_ Dollars (\$\_\_\_\_\_).
- Propose contingency allocation for:
  - 10 cubic yards excavation unit price of \_\_\_\_\_ Dollars / Cubic Yard (\$\_\_\_\_\_ Total)
  - 10 cubic yards crushed aggregate backfill (2A or 2A modified) unit price of \_\_\_\_\_ Dollars / Cubic Yard (\$\_\_\_\_\_ Total)
- Propose to the firm fixed **total** bid sum of \_\_\_\_\_ Dollars (\$\_\_\_\_\_).
- **Commit to complete work no later than 150 calendar days from the issuance of Notice to Proceed.**
- Have received and reviewed the following Addenda (if applicable):
  1. \_\_\_\_\_, dated \_\_\_\_\_.
  2. \_\_\_\_\_, dated \_\_\_\_\_.
  3. \_\_\_\_\_, dated \_\_\_\_\_.

We have included one (1) clearly marked original and two (2) clearly marked copies of the following as our bid:

- ✓ A Bank Cashier's Check, Certified Check or Bid Bond in the amount of \_\_\_\_\_ Dollars (\$\_\_\_\_\_) as required security, this being an amount equivalent to at least ten percent (10%) of the total bid amount. **Please have this as the 1<sup>st</sup> page in your submittal package.**
- ✓ This Bid Form.
- ✓ Documentation as required by Section **3.0**, including the Reference Form.
- ✓ Non-Collusion Affidavit Form.

**NOTE:** The bidder does not need to return the entire set of Bid Documents, Plans, and Specifications. Please be sure to provide the requested number of copies of all bidder provided attachments. Thank you.

***BID FORM – Dry Run Bridge, Northampton, PA. (continued)***

**Communications Concerning this Bid** shall be addressed to:

Contact Person Name: \_\_\_\_\_

Contact Person Title: \_\_\_\_\_

Address: \_\_\_\_\_

\_\_\_\_\_

Telephone Number: \_\_\_\_\_

Fax Number: \_\_\_\_\_

Email Address: \_\_\_\_\_

**Authorized Signature of Bidder**

**When the Bidder is an Individual:**

\_\_\_\_\_  
Name of Bidder

\_\_\_\_\_  
Federal Tax ID Number

\_\_\_\_\_  
Street Address

\_\_\_\_\_  
City State Zip

\_\_\_\_\_  
Telephone Number

\_\_\_\_\_  
Fax Number

\_\_\_\_\_  
Email Address

\_\_\_\_\_  
Signature

\_\_\_\_\_  
Signatory's Name and Title (Printed)

**When the Bidder is a Partnership:**

\_\_\_\_\_  
Name of Partnership

\_\_\_\_\_  
Federal Tax ID Number

\_\_\_\_\_  
Street Address

\_\_\_\_\_  
City State Zip

\_\_\_\_\_  
Telephone Number

\_\_\_\_\_  
Fax Number

\_\_\_\_\_  
Email Address

\_\_\_\_\_  
Signature

\_\_\_\_\_  
Signatory's Name and Title (Printed)

**BID FORM – Dry Run Bridge, Northampton, PA. (continued)**

**When the Bidder is a Corporation:**

\_\_\_\_\_  
Name of Corporation Federal Tax ID Number

\_\_\_\_\_  
Street Address City State Zip

\_\_\_\_\_  
Telephone Number Fax Number Email Address

\_\_\_\_\_  
Signature (\*\* see note below) Signatory's Name and Title (Printed)

\_\_\_\_\_  
Witness's Signature (\*\* see note below) Witness's Name and Title (Printed)

\*\* The President's or Vice President's signature must be attested by the Corporate Secretary or Treasurer. If any employee other than the President or Vice President signs on behalf of the corporation, or if the President's or Vice President's signature is not attested to by the Corporate Secretary or Treasurer, a copy of the corporate resolution authorizing said signature must be attached to this bid. Failure to attach a copy of the appropriate authorization, if required, may result in rejection of the bid.







DISTRICT	COUNTY	ROUTE	SECTION	SHEET
5-0	NORTHAMPTON	9900	D&L	2 OF 4
NORTHAMPTON BOROUGH				
REVISION NUMBER	REVISIONS		DATE	BY

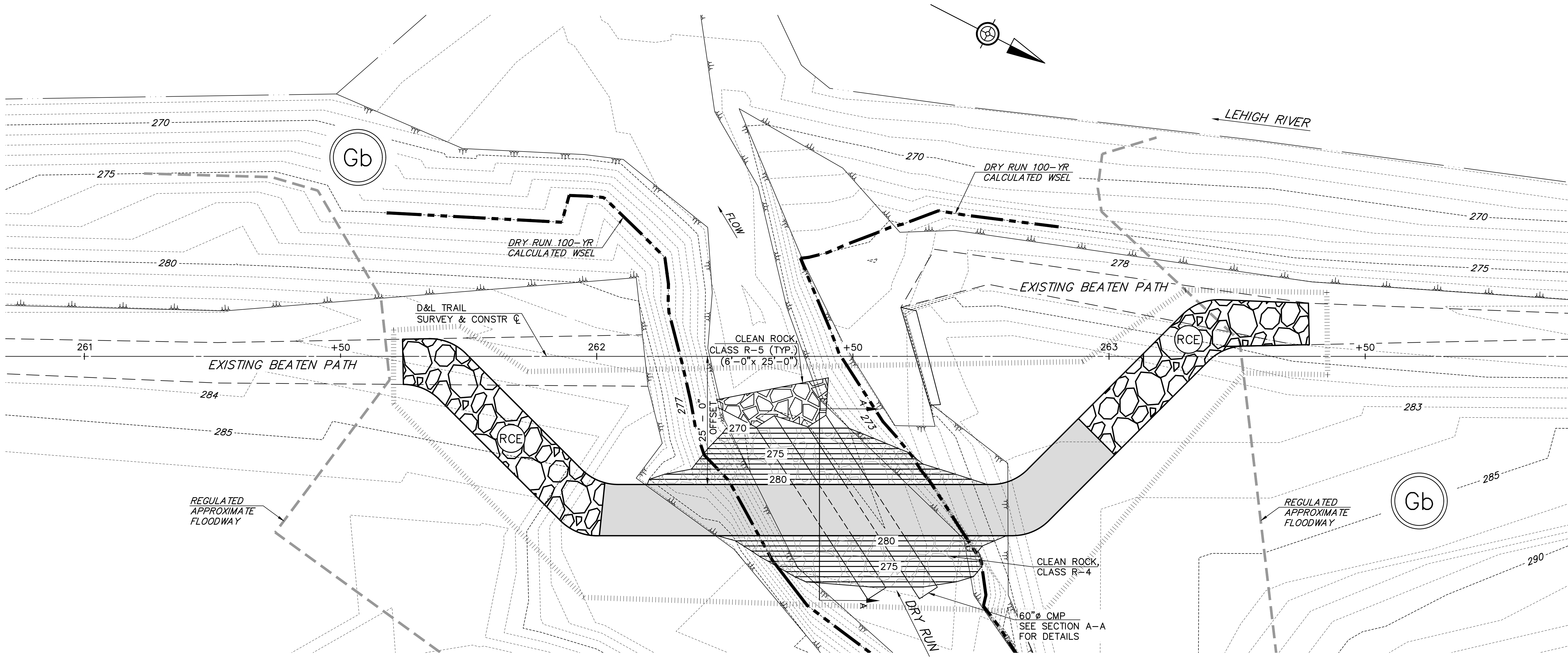

D&L TRAIL GP-8 PLAN

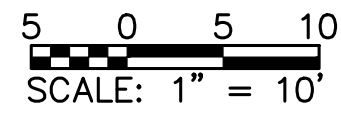

LEGEND:

- DRY RUN 100-YR CALCULATED WSEL
- - - LIMITS OF REGULATED APPROXIMATE FLOODWAY
- 515----- EXISTING CONTOURS
- 515----- PROPOSED CONTOURS
- [Pattern] CLEAN ROCK, CLASS R-4
- [Pattern] CLEAN ROCK, CLASS R-5

- [Symbol] TOP OF BANK
- [Symbol] BOTTOM OF BANK
- LIMITS OF PROPOSED TRAIL
- LIMITS OF WATER
- [Pattern] PROJECT AREA
- [Symbol Gb] SOIL TYPE
- [Pattern RCE] ROCK CONSTRUCTION ENTRANCE

- AREA OF EARTH DISTURBANCE:
- TOTAL EARTH DISTURBANCE = 0 S.F.
  - THE PROPOSED WORK WILL INVOLVE NO DISTURBANCE. THE PROPOSED WORK INCLUDES PLACING GEOTEXTILE, PIPES AND CLEAN ROCK FOR A PROPOSED ACCESS ROAD. NO EARTH MOVING IS PROPOSED FOR THE TEMPORARY CROSSING.
  - SHOULD THE CONTRACTOR PROPOSE ANY DISTURBANCE, THE CONTRACTOR WILL BE SOLELY RESPONSIBLE FOR OBTAINING ANY ADDITIONAL REQUIRED PERMITS OR E&S APPROVALS. ALL SUPPLEMENTAL OR SPECIAL CONDITIONS OF THE DEP PERMIT APPROVAL SHALL APPLY TO THIS PLAN.



DISTRICT	COUNTY	ROUTE	SECTION	SHEET	
5-0	NORTHAMPTON	9900	D&L	3 OF 4	
NORTHAMPTON BOROUGH					
REVISION NUMBER	REVISIONS			DATE	BY

DEP EROSION & SEDIMENT CONTROL PLAN STANDARD NOTES

- ALL EARTH DISTURBANCES, INCLUDING CLEARING AND GRUBBING AS WELL AS CUTS AND FILLS SHALL BE DONE IN ACCORDANCE WITH THE APPROVED E&S PLAN. A COPY OF THE APPROVED DRAWINGS MUST BE AVAILABLE AT THE PROJECT SITE AT AL TIMES. THE NORTHAMPTON COUNTY CONSERVATION DISTRICT SHALL BE NOTIFIED OF ANY CHANGES TO THE APPROVED PLAN PRIOR TO IMPLEMENTATION OF THOSE CHANGES. THE NORTHAMPTON COUNTY CONSERVATION DISTRICT MAY REQUIRE THE WRITTEN SUBMITTAL OF THOSE CHANGES FOR REVIEW AND APPROVAL AT ITS DISCRETION.
- AT LEAST 7 DAYS PRIOR TO STARTING ANY EARTH DISTURBANCE ACTIVITIES, INCLUDING CLEARING AND GRUBBING, THE OWNER AND/OR OPERATOR SHALL INVITE ALL CONTRACTORS, THE LANDOWNER, AND APPROPRIATE MUNICIPAL OFFICIALS, THE E&S PLAN PREPARER, THE E&S PLAN PREPARER, THE LICENSED PROFESSIONAL RESPONSIBLE FOR OVERSIGHT OF CRITICAL STAGES OF IMPLEMENTATION OF THE E&S PLAN, AND A REPRESENTATIVE FROM THE NORTHAMPTON COUNTY CONSERVATION DISTRICT TO AN ON-SITE PRECONSTRUCTION MEETING.
- AT LEAST 3 DAYS PRIOR TO STARTING ANY EARTH DISTURBANCE ACTIVITIES, OR EXPANDING INTO AN AREA PREVIOUSLY UNMARKED, THE PENNSYLVANIA ONE CALL SYSTEM INC. SHALL BE NOTIFIED AT 1-800-242-1776 FOR THE LOCATION OF EXISTING UNDERGROUND UTILITIES.
- ALL EARTH DISTURBANCE ACTIVITIES SHALL PROCEED IN ACCORDANCE WITH THE SEQUENCE PROVIDED ON THE PLAN DRAWINGS. DEVIATION FROM THAT SEQUENCE MUST BE APPROVED IN WRITING FROM THE NORTHAMPTON COUNTY CONSERVATION DISTRICT.
- AREAS TO BE FILLED ARE TO BE CLEARED, GRUBBED, AND STRIPPED OF TOPSOIL TO REMOVE TREES, VEGETATION, ROOTS AND OTHER OBJECTIONABLE MATERIAL.
- CLEARING, GRUBBING, AND TOPSOIL STRIPPING SHALL BE LIMITED TO THOSE AREAS DESCRIBED IN EACH STAGE OF THE CONSTRUCTION SEQUENCE. GENERAL SITE CLEARING, GRUBBING AND TOPSOIL STRIPPING MAY NOT COMMENCE IN ANY STAGE OR PHASE OF THE PROJECT UNTIL THE E&S BMPs SPECIFIED BY THE BMP SEQUENCE FOR THAT STAGE OR SEQUENCE HAVE BEEN INSTALLED AND ARE FUNCTIONING AS DESCRIBED IN THIS E&S PLAN.
- AT NO TIME SHALL CONSTRUCTION VEHICLES BE ALLOWED TO ENTER AREAS OUTSIDE THE LIMIT OF DISTURBANCE BOUNDARIES SHOWN ON THE PLAN MAPS OR INTO WATERS OF THE COMMONWEALTH. THESE AREAS MUST BE CLEARLY MARKED AND FENCED OFF BEFORE CLEARING AND GRUBBING OPERATIONS BEGIN.
- TOPSOIL REQUIRED FOR THE ESTABLISHMENT OF VEGETATION SHALL BE STOCKPILED AT THE LOCATION(S) SHOWN ON THE PLAN MAP(S) IN THE AMOUNT NECESSARY TO COMPLETE THE FINISH GRADING OF ALL EXPOSED AREAS THAT ARE TO BE STABILIZED BY VEGETATION. EACH STOCKPILE SHALL BE PROTECTED IN THE MANNER SHOWN ON THE PLAN DRAWINGS. STOCKPILE HEIGHTS SHALL NOT EXCEED 35 FEET. STOCKPILE SLOPES SHALL BE 2H:1V OR FLATTER.
- IMMEDIATELY UPON DISCOVERING UNFORESEEN CIRCUMSTANCES POSING THE POTENTIAL FOR ACCELERATED EROSION AND/OR SEDIMENT POLLUTION, THE OPERATOR SHALL IMPLEMENT APPROPRIATE BEST MANAGEMENT PRACTICES TO MINIMIZE THE POTENTIAL FOR EROSION AND SEDIMENT POLLUTION AND NOTIFY THE NORTHAMPTON COUNTY CONSERVATION DISTRICT.
- ALL BUILDING MATERIALS AND WASTES SHALL BE REMOVED FROM THE SITE AND RECYCLED OR DISPOSED OF IN ACCORDANCE WITH THE DEPARTMENT'S SOLID WASTE MANAGEMENT REGULATIONS AT 25 PA. CODE 260.1 ET SEQ., 271.1, AND 287.1 ET. SEQ. NO BUILDING MATERIALS OR WASTES OR UNUSED BUILDING MATERIALS SHALL BE BURNED, BURIED, DUMPED, OR DISCHARGED AT THE SITE.
- ALL OFF-SITE WASTE AND BORROW AREAS MUST HAVE AN E&S PLAN APPROVED BY THE DEPARTMENT OF ENVIRONMENTAL PROTECTION AND BE FULLY IMPLEMENTED PRIOR TO BEING ACTIVATED.
- THE CONTRACTOR IS RESPONSIBLE FOR ENSURING THAT ANY MATERIAL BROUGHT ON SITE IS CLEAN FILL. FORM FP-001 MUST BE RETAINED BY THE PROPERTY OWNER FOR ANY FILL MATERIAL AFFECTED BY A SPILL OR RELEASE OF A REGULATED SUBSTANCE BUT QUALIFYING AS CLEAN FILL DUE TO ANALYTICAL TESTING.
- ALL PUMPING OF WATER FROM ANY WORK AREA SHALL BE DONE ACCORDING TO THE PROCEDURE DESCRIBED IN THIS PLAN, OVER UNDISTURBED VEGETATED AREAS.
- UNTIL THE SITE IS STABILIZED, ALL EROSION AND SEDIMENT BMPs SHALL BE MAINTAINED PROPERLY. MAINTENANCE SHALL INCLUDE INSPECTIONS OF ALL EROSION AND SEDIMENT BMPs AFTER EACH RUNOFF EVENT AND ON WEEKLY BASIS. ALL PREVENTATIVE AND REMEDIAL MAINTENANCE WORK, INCLUDING CLEAN OUT, REPAIR, REPLACEMENT, REGRADING, RESEEDING, REMULCHING AND RENETTING MUST BE PERFORMED IMMEDIATELY. IF THE E&S BMPs FAIL TO PERFORM AS EXPECTED, REPLACEMENT BMPs, OR MODIFICATIONS OF THOSE INSTALLED WILL BE REQUIRED.
- A LOG SHOWING DATES THAT E&S BMPs WERE INSPECTED AS WELL AS ANY DEFICIENCIES FOUND AND THE DATE THEY WERE CORRECTED SHALL BE MAINTAINED ON THE SITE AND BE MADE AVAILABLE TO REGULATORY AGENCY OFFICIALS AT THE TIME OF INSPECTION.
- SEDIMENT TRACKED ONTO ANY PUBLIC ROADWAY OR SIDEWALK SHALL BE RETURNED TO THE CONSTRUCTION SITE BY THE END OF EACH WORK DAY AND DISPOSED IN THE MANNER DESCRIBED IN THIS PLAN. IN NO CASE SHALL THE SEDIMENT BE WASHED, SHOVELED, OR SWEEPED INTO ANY ROADSIDE DITCH, STORM SEWER, OR SURFACE WATER.
- ALL SEDIMENT REMOVED FROM BMPs SHALL BE DISPOSED OF IN THE MANNER DESCRIBED ON THE PLAN DRAWINGS.
- AREAS WITH ARE TO BE TOPSOILED SHALL BE SCARIFIED TO A MINIMUM DEPTH OF 3 TO 5 INCHES - 6 TO 12 INCHES ON COMPACTED SOILS - PRIOR TO PLACEMENT OF TOPSOIL. AREAS TO BE VEGETATED SHALL HAVE A MINIMUM OF 4 INCHES OF TOPSOIL IN PLACE PRIOR TO SEEDING AND MULCHING. FILL OUTSLOPES SHALL HAVE A MINIMUM OF 2 INCHES OF TOPSOIL.
- ALL FILLS SHALL BE COMPACTED AS REQUIRED TO REDUCE EROSION, SLIPPAGE, SETTLEMENT, SUBSIDENCE OR OTHER RELATED PROBLEMS. FILL INTENDED TO SUPPORT BUILDINGS, STRUCTURES AND CONDUITS, ECT. SHALL BE COMPACTED IN ACCORDANCE WITH LOCAL REQUIREMENTS OR CODES.
- ALL EARTHEN FILLS SHALL BE PLACED IN COMPACTED LAYERS NOT TO EXCEED 9 INCHES IN THICKNESS.
- FILL MATERIALS SHALL BE FREE OF FROZEN PARTICLES, BRUSH, ROOTS, SOD, OR OTHER FOREIGN OR OBJECTIONABLE MATERIALS THAT WOULD INTERFERE WITH OR PREVENT CONSTRUCTION OF SATISFACTORY FILLS.
- FROZEN MATERIALS OR SOFT, MUCKY OR HIGHLY COMPRESSIBLE MATERIALS SHALL NOT BE INCORPORATED INTO FILLS.
- FILL SHALL NOT BE PLACED ON SATURATED OR FROZEN SURFACES.
- SEEPS OR SPRINGS ENCOUNTERED DURING CONSTRUCTION SHALL BE HANDLED IN ACCORDANCE WITH THE STANDARD AND SPECIFICATION FOR SUBSURFACE DRAIN OR OTHER APPROVED METHOD.
- ALL GRADED AREAS SHALL BE PERMANENTLY STABILIZED IMMEDIATELY UPON REACHING FINISHED GRADE. CUT SLOPES IN COMPETENT BEDROCK AND ROCK FILLS NEED NOT BE VEGETATED. SEEDED AREAS WITHIN 50 FEET OF A SURFACE WATER OR AS OTHERWISE SHOWN ON THE PLAN DRAWINGS, SHALL BE BLANKETED ACCORDING TO THE STANDARDS OF THIS PLAN.
- IMMEDIATELY AFTER EARTH DISTURBANCE ACTIVITIES CEASE IN ANY AREA OR SUBAREA OF THE PROJECT, THE OPERATOR SHALL STABILIZE ALL DISTURBED AREAS. DURING NON-GERMINATING MONTHS, MULCH OR PROTECTIVE BLANKETING SHALL BE APPLIED AS DESCRIBED IN THE PLAN. AREAS NOT AT FINISHED GRADE, WHICH WILL BE REACTIVATED WITHIN 1 YEAR, MAY BE STABILIZED IN ACCORDANCE WITH THE TEMPORARY STABILIZATION SPECIFICATIONS. THOSE AREAS WHICH WILL NOT BE REACTIVATED WITHIN 1 YEAR SHALL BE STABILIZED IN ACCORDANCE WITH THE PERMANENT STABILIZATION SPECIFICATIONS.
- PERMANENT STABILIZATION IS DEFINED AS A MINIMUM UNIFORM, PERENNIAL 70% VEGETATIVE COVER OR OTHER PERMANENT NON-VEGETATIVE COVER WITH A DENSITY SUFFICIENT TO RESIST ACCELERATED EROSION. CUT AND FILL SLOPES SHALL BE CAPABLE OF RESISTING FAILURE DUE TO SLUMPING, SLIDING, OR OTHER MOVEMENTS.
- E&S BMPs SHALL REMAIN FUNCTIONAL AS SUCH UNTIL ALL AREAS TRIBUTARY TO THEM ARE PERMANENTLY STABILIZED OR UNTIL THEY ARE REPLACED BY ANOTHER BMP APPROVED BY THE LOCAL CONSERVATION DISTRICT OR THE DEPARTMENT.
- UPON COMPLETION OF ALL EARTH DISTURBANCE ACTIVITIES AND PERMANENT STABILIZATION OF ALL DISTURBED AREAS, THE OWNER AND/OR OPERATOR SHALL CONTACT THE NORTHAMPTON COUNTY CONSERVATION DISTRICT FOR AN INSPECTION PRIOR TO REMOVAL/CONVERSION OF THE E&S BMPs.
- AFTER FINAL SITE STABILIZATION HAS BEEN ACHIEVED, TEMPORARY EROSION AND SEDIMENT BMPs MUST BE REMOVED OR CONVERTED TO PERMANENT POST CONSTRUCTION STORMWATER MANAGEMENT BMPs. AREAS DISTURBED DURING REMOVAL OR CONVERSION OF THE BMPs SHALL BE STABILIZED IMMEDIATELY. IN ORDER TO ENSURE RAPID REVEGETATION OF DISTURBED AREAS, SUCH REMOVAL CONVERSIONS ARE TO BE DONE ONLY DURING THE GERMINATING SEASON.
- UPON COMPLETION OF ALL EARTH DISTURBANCE ACTIVITIES AND PERMANENT STABILIZATION OF ALL DISTURBED AREAS, THE OWNER AND/OR OPERATOR SHALL CONTACT THE NORTHAMPTON COUNTY CONSERVATION DISTRICT TO SCHEDULE A FINAL INSPECTION.
- FAILURE TO CORRECTLY INSTALL E&S BMPs, FAILURE TO PREVENT SEDIMENT-LADEN RUNOFF FROM LEAVING THE CONSTRUCTION SITE, OR FAILURE TO TAKE IMMEDIATE CORRECTIVE ACTION TO RESOLVE FAILURE OF E&S BMPs MAY RESULT IN ADMINISTRATIVE, CIVIL, AND/OR CRIMINAL PENALTIES BEING INSTITUTED BY THE DEPARTMENT AS DEFINED IN SECTION 602 OF THE PENNSYLVANIA CLEAN STREAMS LAW. THE CLEAN STREAMS LAW PROVIDES FOR UP TO \$10,000 PER DAY IN CIVIL PENALTIES, UP TO \$10,000 IN SUMMARY CRIMINAL PENALTIES, AND UP TO \$25,000 IN MISDEMEANOR CRIMINAL PENALTIES FOR EACH VIOLATION.
- ROCK CONSTRUCTION ENTRANCES SHALL BE USED AT EACH APPROACH OR AS REQUIRED.
- THERE ARE NO NATURALLY OCCURRING GEOLOGIC FORMATIONS OR SOIL CONDITIONS THAT HAVE THE POTENTIAL TO CAUSE POLLUTION.
- THERMAL IMPACTS HAVE BEEN MINIMIZED BY PROVIDING A TEMPORARY CROSSING. ANY RUNOFF WILL FLOW OVER VEGETATED AREAS BEFORE REACHING SURFACE WATERS.
- THE PAST, PRESENT, AND PROPOSED LAND USES FOR THIS BRIDGE HAVE BEEN AND WILL REMAIN TRANSPORTATION RELATED.

STAGING OF CONSTRUCTION

- DELINEATE ALL LIMITS OF WORK AND RIGHT-OF-WAY LINES. FIELD MARK THE LIMITS OF WORK.
- INSTALL GEOTEXTILE, ROCK CONSTRUCTION ENTRANCES, AND TEMPORARY CROSSING APPROACH SURFACE.
- INSTALL GEOTEXTILE, PIPES, OUTLET PROTECTION, AND CROSSING TYPICAL SECTION.
- WHEN THE TEMPORARY CROSSING IS NO LONGER NEEDED REMOVE THE CROSSING AND APPROACH TRAIL TAKING CARE TO NOT DISTURB THE GROUND UNDER THE GEOTEXTILE. IF SEEDING IS REQUIRED FOLLOW THE REQUIREMENTS OF PERMANENT SEEDING AND MULCHING.

PERMANENT SEEDING AND MULCHING

- PROVIDE THE FOLLOWING SEEDING MIXTURE (REFER TO PUB. 408, SECTION 804 FOR SEED SPECIES)(IF REQUIRED):
- FORMULA D:  
APPLICATION RATE (LB/1000SY): 21  
FERTILIZER TYPE: 10-20-20  
FERTILIZER RATE (LB/1000SY): 140  
LIMING TYPE: AGRICULTURAL GRADE  
LIMING RATE (LB/1000SY): 800  
MULCHING TYPE: STRAW OR HAY  
MULCHING RATE: (LB/1000SY) 1200  
SEEDING DATES: 3/15 TO 6/1  
AND 8/1 TO 10/15
- REFER TO PUB. 408, SECTION 804 FOR SITE PREPARATION, SEEDING METHODS, WEED CONTROL, ETC.
- INSPECT SEEDED AREAS WEEKLY AND AFTER EACH RAINFALL EVENT, ERODED AREAS ARE TO HAVE TOPSOIL REPLACED, SEED RESOWN AND MULCH REAPPLIED.
- REFER TO PUB. 408, SECTION 805 FOR THE REQUIREMENTS FOR FURNISHING, PLACING, ANCHORING AND MAINTAINING MULCH COVER.
- STRAW MULCH WILL BE APPLIED OVER SEEDED AREAS NO LATER THAN 48 HOURS AFTER SEEDING.
- SPREAD MULCH UNIFORMLY, IN A CONTINUOUS BLANKET.
- MULCH MAY BE SPREAD BY HAND OR WITH AN ACCEPTABLE MECHANICAL BLOWER.

SOILS INFORMATION

SYMBOL	NAME	LIMITATIONS		
		LOCAL ROADS, STREETS	SHALLOW EXCAVATIONS	LAWNS, AND LANDSCAPING
Gb	GILBRALTAR SILT LOAM	VERY LIMITED FROST ACTION (1.00) LOW STRENGTH (1.00) FLOODING (0.40)	SOMEWHAT LIMITED DEPTH TO SATURATED ZONE (0.61) DUSTY (0.03) UNSTABLE EXCAVATION WALLS (0.01)	SOMEWHAT LIMITED LOW EXCHANGE CAPACITY (0.75) DUSTY (0.03)

- ONSITE INVESTIGATION MAY BE NEEDED TO VALIDATE THE INTERPRETATIONS IN THIS TABLE AND TO CONFIRM THE IDENTITY OF THE SOIL ON A GIVEN SITE. THE NUMBERS IN PARENTHESIS RANGE FROM 0.01 TO 1.00. THE LARGER THE VALUE, THE GREATER THE POTENTIAL LIMITATION. THE TABLE SHOWS ONLY THE TOP FIVE LIMITATIONS FOR ANY GIVEN SOIL. THE SOIL MAY HAVE ADDITIONAL LIMITATIONS.
- THE SOIL LIMITATIONS HAVE BEEN ADDRESSED IN DESIGN BY PROVIDING METHODS TO PREVENT EARTH DISTURBANCE.





DISTRICT	COUNTY	ROUTE	SECTION	SHEET	
5-0	NORTHAMPTON	9900	D&L	4 OF 4	
NORTHAMPTON BOROUGH					
REVISION NUMBER	REVISIONS			DATE	BY

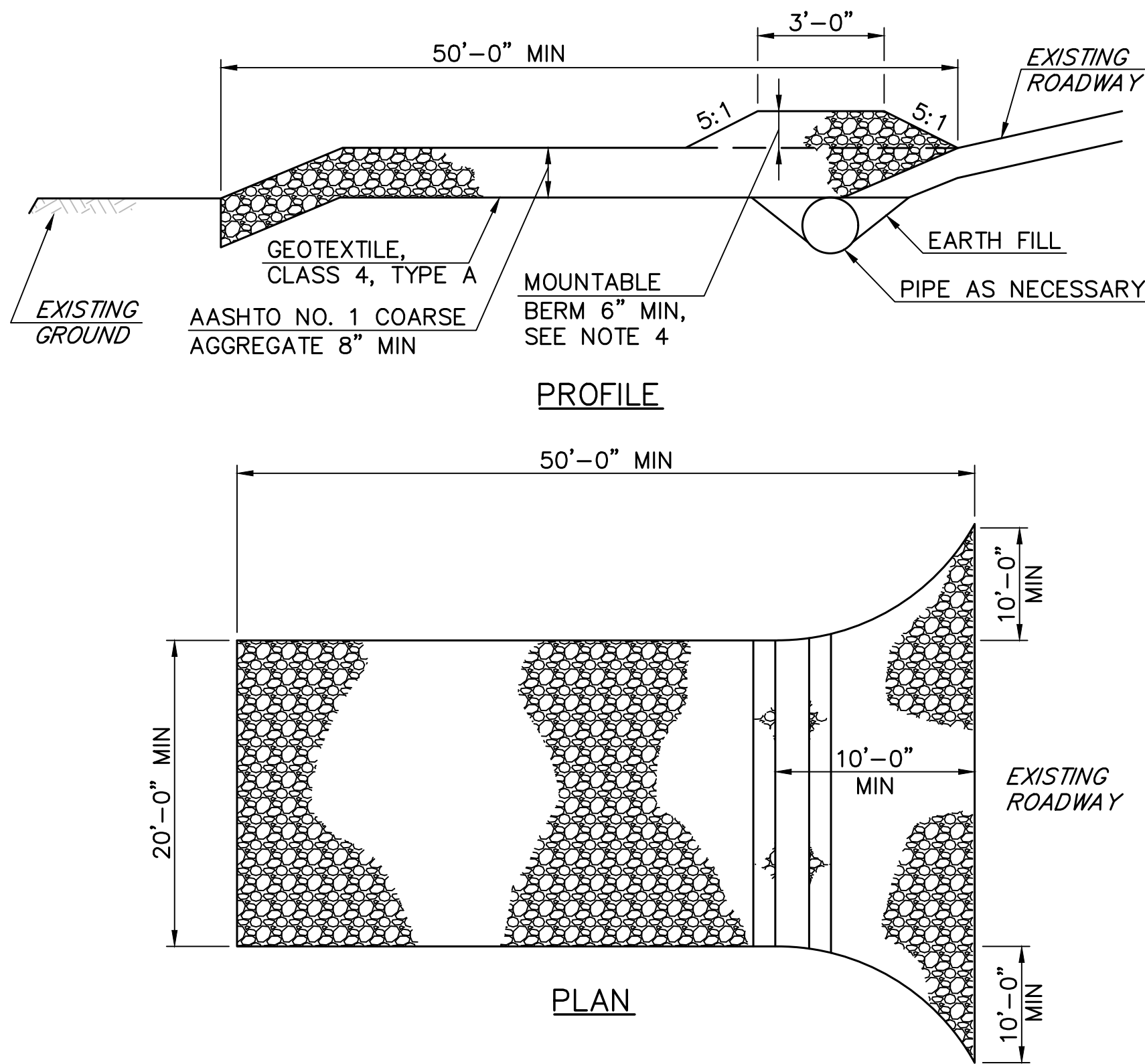

NOTES

1. INSPECT THE ENTRANCE DAILY. REMOVE ALL SEDIMENT DEPOSITED ON THE PUBLIC ROADWAYS AND RETURN TO THE CONSTRUCTION SITE. WASHING OF THE ROADWAY WILL NOT BE PERMITTED.
2. MAINTAIN THE SPECIFIED ROCK CONSTRUCTION ENTRANCE THICKNESS. PLACE ADDITIONAL ROCK WHENEVER ROCK BECOMES CLOGGED WITH SEDIMENT.
3. MAINTAIN STOCKPILE OF AASHTO NO. 1 COARSE AGGREGATE.
4. CONSTRUCT A MOUNTABLE BERM ONLY WHEN 6" MIN COVER CANNOT BE PROVIDED OVER THE PIPE.
5. SATISFACTORILY REMOVE MATERIALS AS PER SPECIFICATION IN SECTION 849 WHEN ROCK CONSTRUCTION ENTRANCE IS NO LONGER NEEDED.
6. PROVIDE GEOTEXTILE MATERIAL MEETING THE REQUIREMENTS OF PUBLICATION 408, SECTION 735. FURNISH AND INSTALL IN ACCORDANCE WITH SECTION 212. PROVIDE GEOTEXTILE ALONG ALL INTERFACE AREAS WITH GROUND CONTACT.
7. CONSTRUCT ROCK CONSTRUCTION ENTRANCE WITHIN THE RIGHT-OF-WAY OR EASEMENT AREAS. ENTRANCE MAY BE CONSTRUCTED ON A SKEW IF ADEQUATE PULL OUT SIGHT DISTANCE IS AVAILABLE.

ROCK CONSTRUCTION ENTRANCE  
NOT TO SCALE

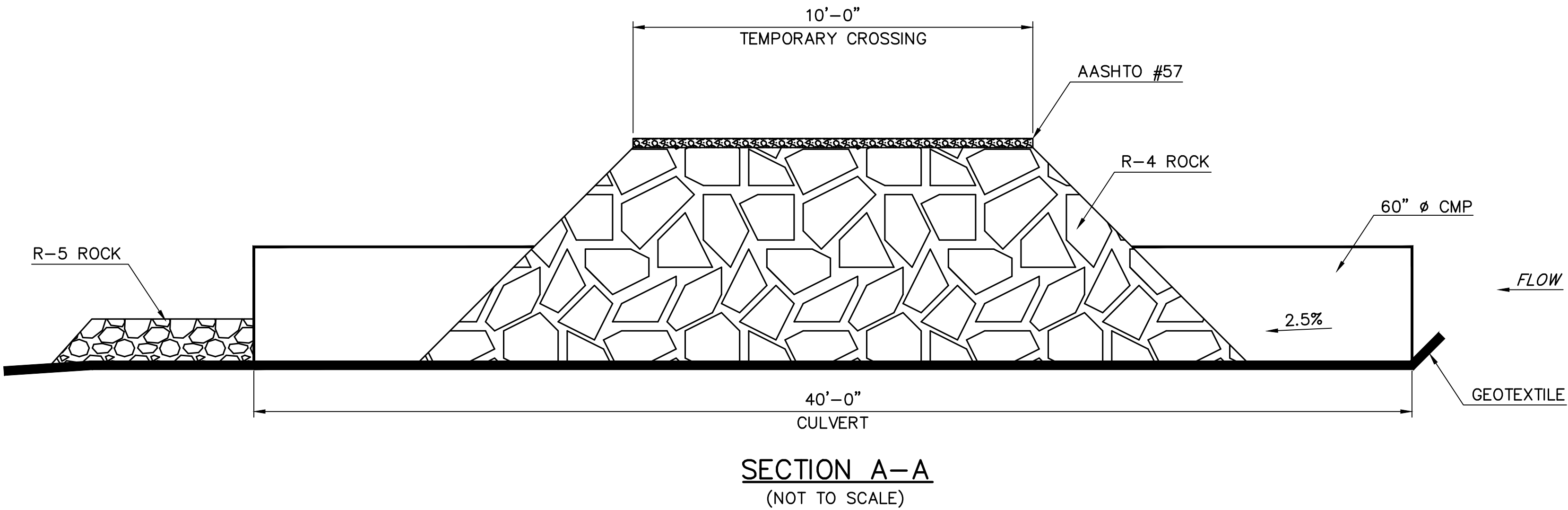

NOTES

1. CONTRACTOR IS TO PLACE PIPE IN ACCORDANCE WITH MANUFACTURERS RECOMMENDATIONS.
2. PIPE SHALL HAVE A MANNING'S 'n' VALUE OF 0.025 OR LESS.
3. CONTRACTOR SHALL CHECK PIPE AND CROSSING WEEKLY AND AFTER ANY RAIN EVENT.

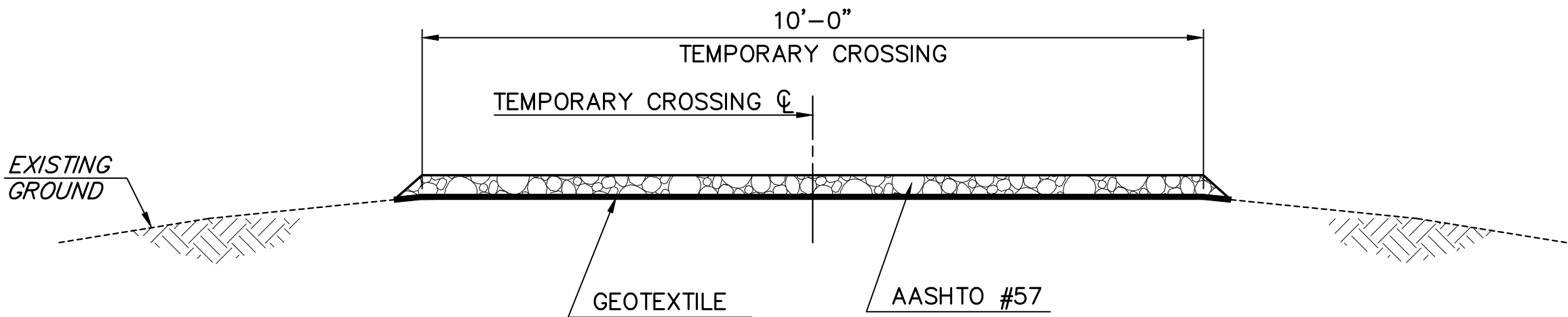

TYPICAL APPROACH SECTION  
(NOT TO SCALE)

